

# CPHCE Bi-monthly Newsletter

March – April 2023

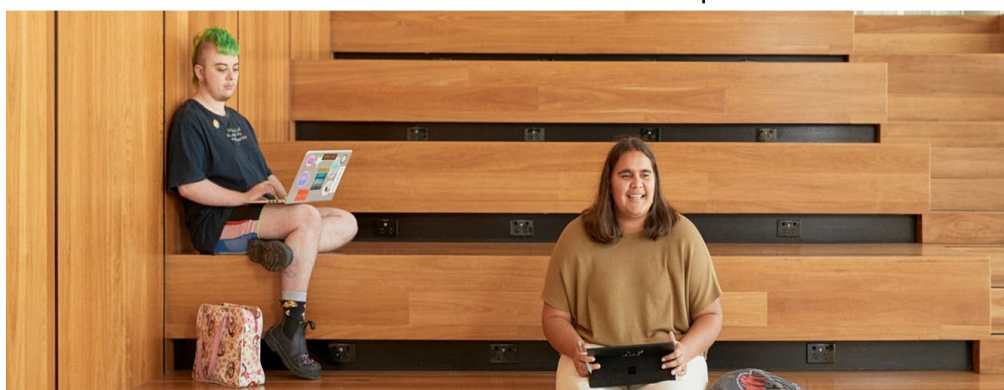

## Highlights

- **CPHCE Staff Day** was held on Wednesday 19<sup>th</sup> April 2023 at Casula Powerhouse Museum. The day was filled with a variety of engaging and informative sessions, including overview of Miller (past, present and future), workshops on active bystander, and updates of each stream at CPHCE. There were also opportunities for staff to share their own experiences and insights, which helped to foster a sense of community and collaboration. In addition to the workshops, the staff enjoyed a delicious catered lunch and participated in some fun team-building activities.
- The presentation titled **Miller: CHETRE's journey through time** at the CPHCE Staff Day showcased the history and significant accomplishments of CHETRE/CPHCE UNSW in their locational disadvantage work in Miller since 1999. The presentation featured speakers such as Professor Elizabeth Harris, Joan Silk, and Andrew Reid, who discussed the birth, importance, and achievements of CHETRE's Community STaR program that aims to promote a safe, healthy, and vibrant local community through social justice, community empowerment, fairness, and evidence-based action research. The presentation concluded with highlighting CHETRE's ongoing presence in Miller and some of the program's achievements since 2018, such as the delivery of the sixth cross-sectional randomized household survey in the area since 1999.

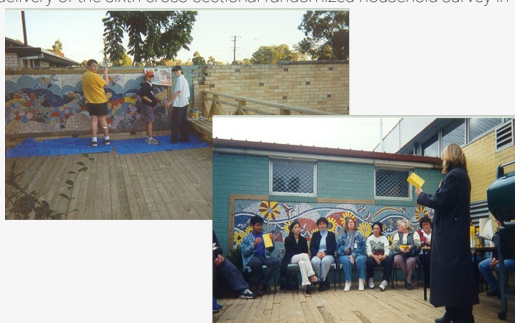

## Work with the Waterloo community

We are working closely with services organisations and community groups in the Waterloo area. Specifically undertaking the review of the Waterloo Health Services Action Plan, undertaking the Peer Wellbeing educators project and the supporting the Waterloo estate redevelopment health impact assessment.

### Review of the Waterloo Human Services Action Plan

The Waterloo Human Services Collaborative Group was established to assist with engagement, planning and coordinated responses by human services agencies to the Waterloo community, in advance of the Waterloo Estate redevelopment. This group developed the Waterloo Human Services Action Plan (Plan). The review of the Plan being led by A/Prof Margo Barr at CPHCE and A/Prof Fiona Haigh at Health Equity Research and Development Unit (HERDU) is being undertaken to better understand: the functioning and partnerships of the Waterloo Human Services Collaborative Group; the current status of the processes and implementation of the Plan and the impact of it. In order to do this we: developed a program logic model, surveyed all of the members of the Collaborative Group using the Waterloo Partnership analysis checklist questionnaire, developed by HERDU, and reported on the findings; conducted in-depth interviews with members of the Collaborative Group to better understand progress and barriers; and designed and surveyed social housing tenants using the Waterloo Outcomes Tenant Survey in collaboration with community groups. The social housing tenants have been encouraged to participate via SMS messaging, posters as well as community events such as Summer on the Green (see picture attached which includes Cathy O'Callaghan and Margaret Williamson from CPHCE). Finding from the in-depth interviews and the tenant survey are currently being finalised.

### Peer Wellbeing Educators

The Waterloo Peer Wellbeing Educators project is a community-led project, training local people to be information gatherers and health educators using a peer champion model. HERDU helped develop the project and is providing research and evaluation support as it is being implemented.

#### Waterloo Estate Redevelopment Health Impact Assessment

HERDU is supporting the second stage of the Health Impact Assessment of the Waterloo estate redevelopment. The first stage focused on the impacts on tenants of the redevelopment announcement and the wait to be rehoused, with HERDU finalising the draft report and recommendations in 2019. The second stage is community led under the auspice of Counterpoint Community Services. Community-led HIA is an evidence-informed and practical way in which communities can contribute to decisions. It is a democratic and political process, rather than a technocratic one. HERDU is providing facilitation, technical and logistical support. The screening report has been completed and scoping workshops with the community and stakeholders have commenced.

## New people

### **Ms Sarah Wright (she/her), Research Officer**

Sarah joined CPHCE as a research officer on the Community Health Workers Extending Care in the Community (CHECC) trial in March 2023. Before this, Sarah worked at Family Planning NSW for five years as the HREC coordinator and conducted research for projects on contraception and abortion provision, and nurse/midwife-led models of care. She particularly enjoys developing innovative solutions to overcome ethical approval barriers that can impede research projects.

### **Dr Beatriz Lopez Portillo, Research Manager SHAReD Study**

Beatriz (she/her) started at CPHCE in March 2023 to coordinate the SHAReD Study, a joint project with the Sydney Local Health District. Beatriz commenced her career in romantic relationship research about 10 years ago at the National Autonomous University of Mexico and made a career change to public health in recent years. She works closely with Catherine Spooner and Snow Li, as well as many other investigators and project team members in the SHAReD Study project. Beatriz spends most of her time of the week at Marrickville Community Health Centre and comes to CPHCE Randwick office on Thursday.

## Communication

- Dr Patrick Harris (2nd to the right) was awarded inaugural funding under the new Project Mezze seed funding scheme. The scheme funded projects that have co-leads from WSU and UNSW and focus on bringing positive social impact and enhancing liveability and engagement within Western Sydney communities. Patrick's (UNSW) and Prof Nicky Morrison's (WSU) project is focussed on action to address urban heat governance and implementation in Western Sydney.



- Sabuj Kanti Mistry submitted his PhD thesis to the UNSW Graduate Research School in March 2023.
- **Emilia Rönkkö – Visiting Fellow**  
In March's CPHCE lunchtime seminar, Docent Emilia Rönkkö spoke about RECIPE (Resistant Cities: Urban Planning as Means for Pandemic Prevention) which explores the role of urban living environments and the potential of urban planning in anticipation and prevention of infectious disease and thus pandemic outbreaks. Her research is addressing the gap that infectious disease is largely been neglected in urban planning, even though global urbanisation continues, and many past and recent pandemics have originated and spread in cities. Along with climate change, new kinds of threats are formed by increasing floods, zoonoses and the thawing permafrost, which makes it increasingly probable that serious epidemics will become common in the future. The project engages citizens, SMEs, planners and health professionals, cross-sectional institutions, and decision makers to develop tools and methods for resistant urban planning and encourages cross-sectorial discussions and integrative policies between urban planning and health sectors.



- A short radio documentary about our [Gaawaadhi Gadudha and the cultural camps](#) was broadcasted on ABC Radio National and ABC Away.

### Publications

- [Actually existing intersectionality: The place-based and embodied politics of animal and human rights activism](#)  
By Esther Alloun
- [Application of Artificial Intelligence in Assessing the Self-Management Practices of Patients with Type 2 Diabetes](#)  
By Rashid Ansari, Mark Harris & more
- [Place-making and its impact on health and wellbeing among recently resettled refugees in high income contexts: A scoping review](#)  
By Aryati Yashadhana, Esther Alloun, Nina Serova, Evelyn de Leeuw & more
- [Bullying Victimization and Suicidal Behavior among adolescents in 28 Countries and Territories: A Moderated Mediation Model](#)  
By Prince Peprah & more
- [Racially minoritized people's experiences of racism during COVID-19 in Australia: A qualitative study](#)  
By Aryati Yashadhana & more
- [A moderated mediation analysis of the association between smoking and suicide attempts among adolescents in 28 countries](#)  
By Prince Peprah & more
- [In it for the long haul: the complexities of managing overweight in family practice: qualitative thematic analysis from the Health eLiteracy for Prevention in General Practice \(HeLP-GP\) trial](#)  
By Katrina Paine, Sharon Parker, Shoko Saito, Mark Harris & more
- [Inter-sectoral policy partnerships: a case study of South Western Sydney's Health and Housing Partnership](#)  
By Karla Jaques, Fiona Haigh & more
- [Health Promotion Political Research as Policy Practice](#)  
By Evelyn de Leeuw
- [Policymaker and Practitioner Perceptions of Parks for Health and Wellbeing: Scoping a Holistic Approach](#)  
By Evelyn de Leeuw & more

Follow CPHCE on Twitter

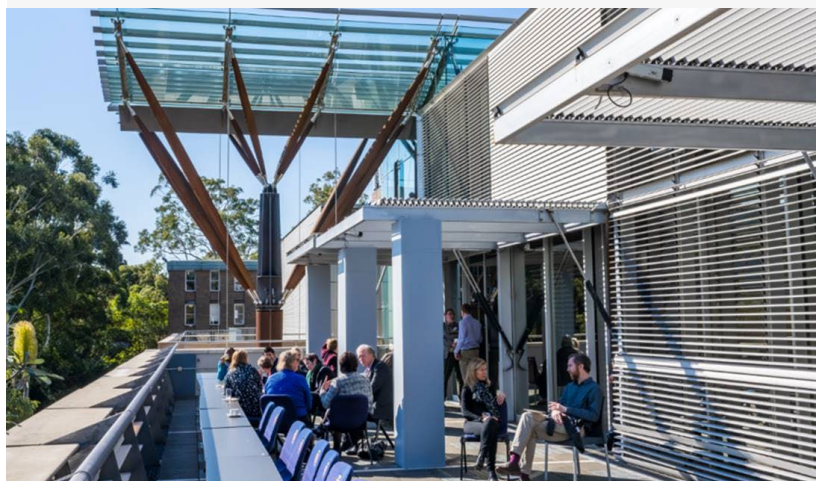

Follow us!



Copyright © 2023 UNSW Sydney. All Rights Reserved.  
Cricos Provider Code 00098G