

# Maximilienne Whitby

People and Place Research Cluster Talk 2018

# Design for Neurodiversity

Inclusive Design

Accessible Design

Universal Design

Environmental  
Psychology

Behavioural Psychology

Building Analysis (POEs)

Mental Disability

Neurodevelopmental  
Disability

Neuroscience

Maximilienne WHITBY



# Overview of Existing Work

Maximilienne WHITBY



# Making Space

2016 Project investigating barriers and spatial needs to use of public buildings for users with lived experiences of Autism Spectrum Disorder (ASD) and Borderline Personality Disorder (BPD) during Sensory Overload (ASD) and Dissociation (BPD).

Maximilienne WHITBY



# Cambridge Workshop on Universal Access and Assistive Technology (CWUAAT18)

Breaking down barriers between disciplines

Breaking down barriers between users, designers and developers

Removing barriers to usability, accessibility and inclusive design

Breaking down barriers between people with impairments and those without

Breaking down barriers between scientists and policy makers

Removing barriers to open data and open government

Recent barriers to effective rehabilitation robotics

Maximilienne WHITBY



# Composite Mapping for Evaluation of Usability of Targeted Affordances

The development and use of a composite mapping methodology within the Sydney Opera House sought a greater understanding of potential barriers to use of targeted affordances for public building users with lived experiences of Autism Spectrum Disorder (ASD) and Borderline Personality Disorder (BPD).

Maximilienne WHITBY





Behavioural Mapping



Environmental Psychology Theory



Map to measure how usable the case study locations are

# Why does usability matter?

\*and also, why is it hard to measure?



How does the behaviour of other people impact how usable a building is for users with ASD or BPD?

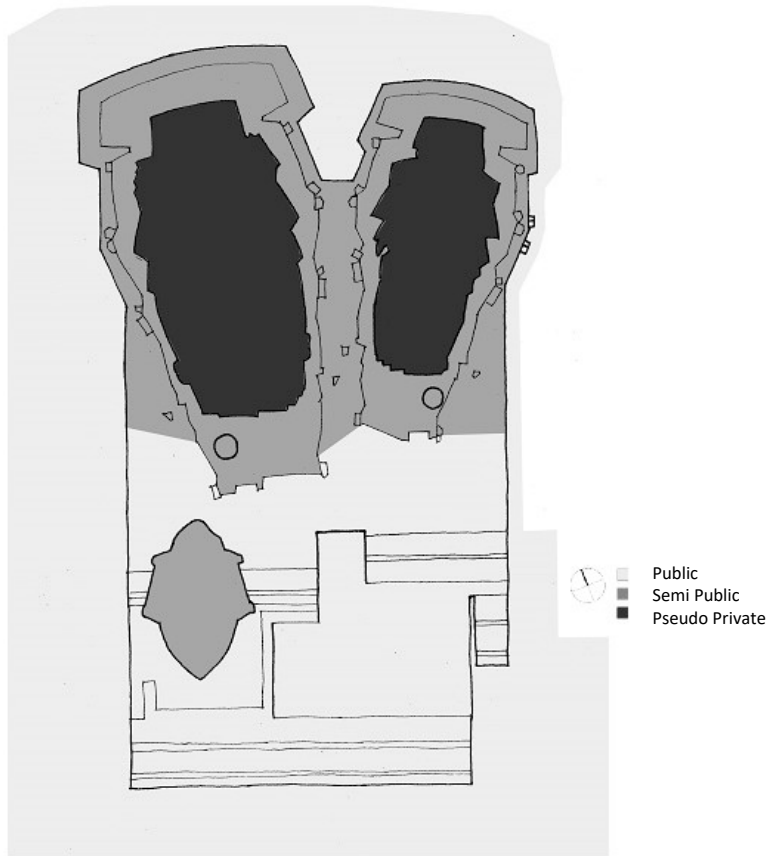

Hierarchy gradient of publicness territorial zones: podium level Sydney Opera House

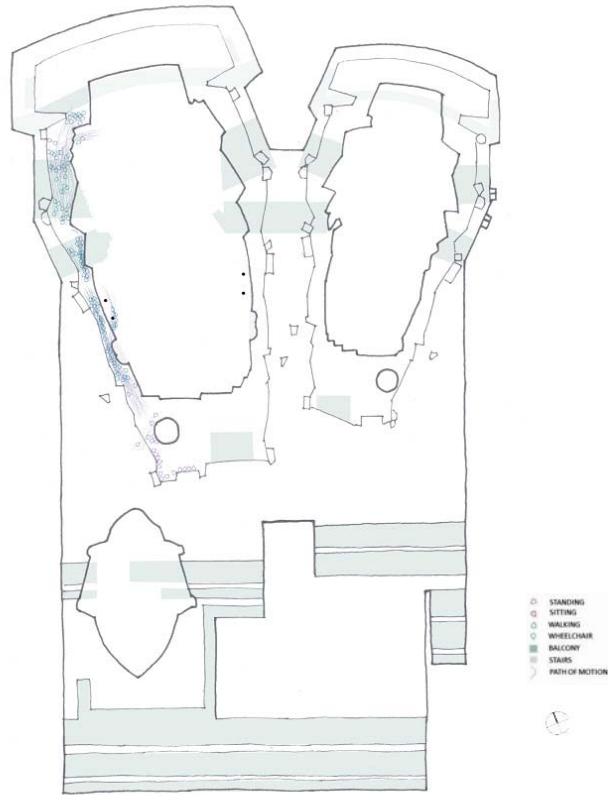

# Observational behavioural mapping pre matinee Sydney Opera House

Maximilienne WHITBY





# Composite mapping matinee Sydney Opera House

Maximilienne WHITBY

# Case study location 4

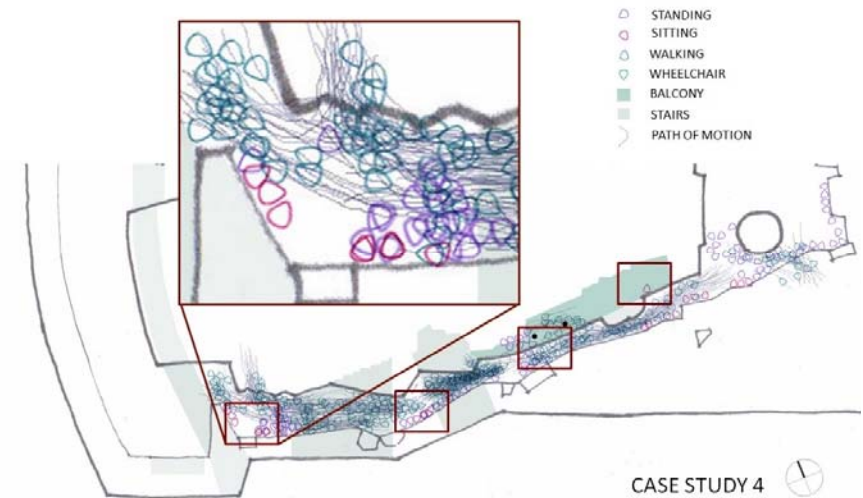

Maximilienne WHITBY

# Where can I find the wider results of the project?

Whitby M (2017b) Scoping of Shared Spatial Needs. Journal of Urban Design and Mental Health. Centre for Urban Design and Mental Health

Whitby M (2018) Composite Mapping for Evaluation of Usability of Targeted Affordances, Proceedings of the 9th Cambridge Workshop on Universal Access and Assistive Technologies, Springer, and Fitzwilliam College, University of Cambridge, Cambridge, United Kingdom

Maximilienne WHITBY



# PhD Overview

Maximilienne  
WHITBY



# Towards Design for Neurodiversity:

Person Environment Fit Implications of Atypical  
Somatosensory Function in Neurodiverse Adults.

Maximilienne  
WHITBY





# Overview

Mixed Methodology

Systematic Literature Review

Spatial Precedent Studies

Semi Structured Interviews

Surveys

Card Sort

Object Sort

Key Words

Neurodiverse

Person-Environment Fit

Somatosensory

Inclusive Design

Knowledge Exchange

# Participants

- 45% of all Australians will experience a mental or behavioural condition in their lifetime.  
(Australian Bureau of Statistics, 2010)
- 17.5 % of Australians experience mental or behavioural conditions at any one point in time.  
That is over 4 million people right now. (Australian Bureau of Statistics, 2015)
- 14.4% of Adults in Australia have an Anxiety Disorder (Australian Bureau of Statistics, 2008)
- 5.4 % of Australian Adults currently have some type of Depression (Australian Bureau of Statistics, 2008)
- 1.8% of Adult Australians have a diagnosis of a Bipolar Disorder Australian Bureau of Statistics, 2008)
- Between 1-3.5% of Australians over the age of 18 have Borderline Personality Disorder  
(Australian Government National Health and Medical Research Council, 2012)
- Between 0.7% and 2% of Australians have Autism Spectrum Disorder (Australian Bureau of Statistics, 2017)

# Methodology Overview

Systematic Search

**Phase 1**

Spatial Precedent  
Scouting

**Phase 2**

Semi Structured  
Interviews

- Surveys
- Card Sort
- Object Sort

**Phase 3**

# References

- Alexander C, Ishikawa S, Silverstein M (1977) *A Pattern Language*. Oxford University Press, New York
- Gibson J (1979) *The Ecological Approach to Visual Perception*. Houghton Mifflin, Boston
- Gill D, Warburton W, (2014) An Investigation of the Biosocial Model of Borderline Personality Disorder. *Journal of Clinical Psychology* 70(9): 866–873
- Groat L, Wang D, (2013) *Architectural Research Methods*. Wiley, New Jersey
- Imrie R, Hall P (2001) *Inclusive Design: Designing and Developing Accessible Environment*. Spon Press, London
- Lang J (1987) *Creating Architectural Theory*. Van Nostrand Reinhold, New York
- McCay L (2015) We should think more about the link between urban design and mental health. *Journal of Urban Design and Mental Health*. Centre for Urban Design and Mental Health
- Newman O (1972) *Defensible Space*. Macmillan, New York
- Preiser W, Rabinowitz H, White E (1988) *Post-Occupancy Evaluation*. Van Nostrand Reinhold, USA
- Rydén G, Rydén E, Hetta J (2008) Borderline personality disorder and Autism Spectrum Disorder in females. *Clinical Neuropsychiatry* 5(1): 22-30
- Smith S (2008) *The relationship among adaptive behavior, empathizing, systemizing, sensory issues and the Temperament of adolescents with Autism Spectrum Disorder*. PhD diss., University of Kansas, USA
- Sommer R, Sommer B (2002) *A Practical Guide to Behavioral Research: Tools and Techniques*. Oxford University Press, New York
- Sommer R (1969) *Personal Space: The Behavioral Basis of Design*. Prentice-Hall, New Jersey
- Steinfeld E (1979) *Access to the Built Environment (HUD-000060)* United States Department of Housing, Urban Development. Office of Policy Development, Research, and Syracuse University. Washington
- World Health Organization (1992) *The ICD-10 Classification of Mental and Behavioural Disorders: Diagnostic criteria for research*. World Health Organization, Geneva
- Whitby M, Ameen S (2016) *Rituals, Video*, University of New South Wales, Sydney, Australia
- Whitby M (2017a) *Making Space*. Honours Thesis. University of New South Wales, Sydney
- Whitby M (2017b) *Scoping of Shared Spatial Needs*. *Journal of Urban Design and Mental Health*. Centre for Urban Design and Mental Health
- Whitby M (2018) *Composite Mapping for Evaluation of Usability of Targeted Affordances*, Proceedings of the 9th Cambridge Workshop on Universal Access and Assistive Technologies, Springer, and Fitzwilliam College, University of Cambridge, Cambridge, United Kingdom